

iPad Stand Pro Hybrid Clamp

Applicable Products:

IPHC1 (Single)
IPHC2 (Double)

1. Screw together the two upright sections (fig. A).
2. Slide top clamp over upright and screw knob into place at desired location (fig. B).
3. Slide upright into bottom clamp and screw knob into place at desired location (fig. C).
4. Open clamps and insert graphic (not shown).
5. Align tablet upright over base. Feed tablet cord through center hole and screw into place using two Allen head screws provided.
When inserting screws, tighten BOTH by hand first. Then, fully tighten using an Allen key (fig. D-1).
6. Align clamp upright over base and screw into place using Phillips head screw provided (fig. D-2).
7. Remove acrylic cover using small tamper-proof key provided. Place tablet inside and reassemble unit (fig. E). If ball joint loosens on back, use the large tamper-proof key to retighten it securely.

Note: Clamps shown below are for the IPHC2 stand, but setup is the same for the IPHC1 stand.

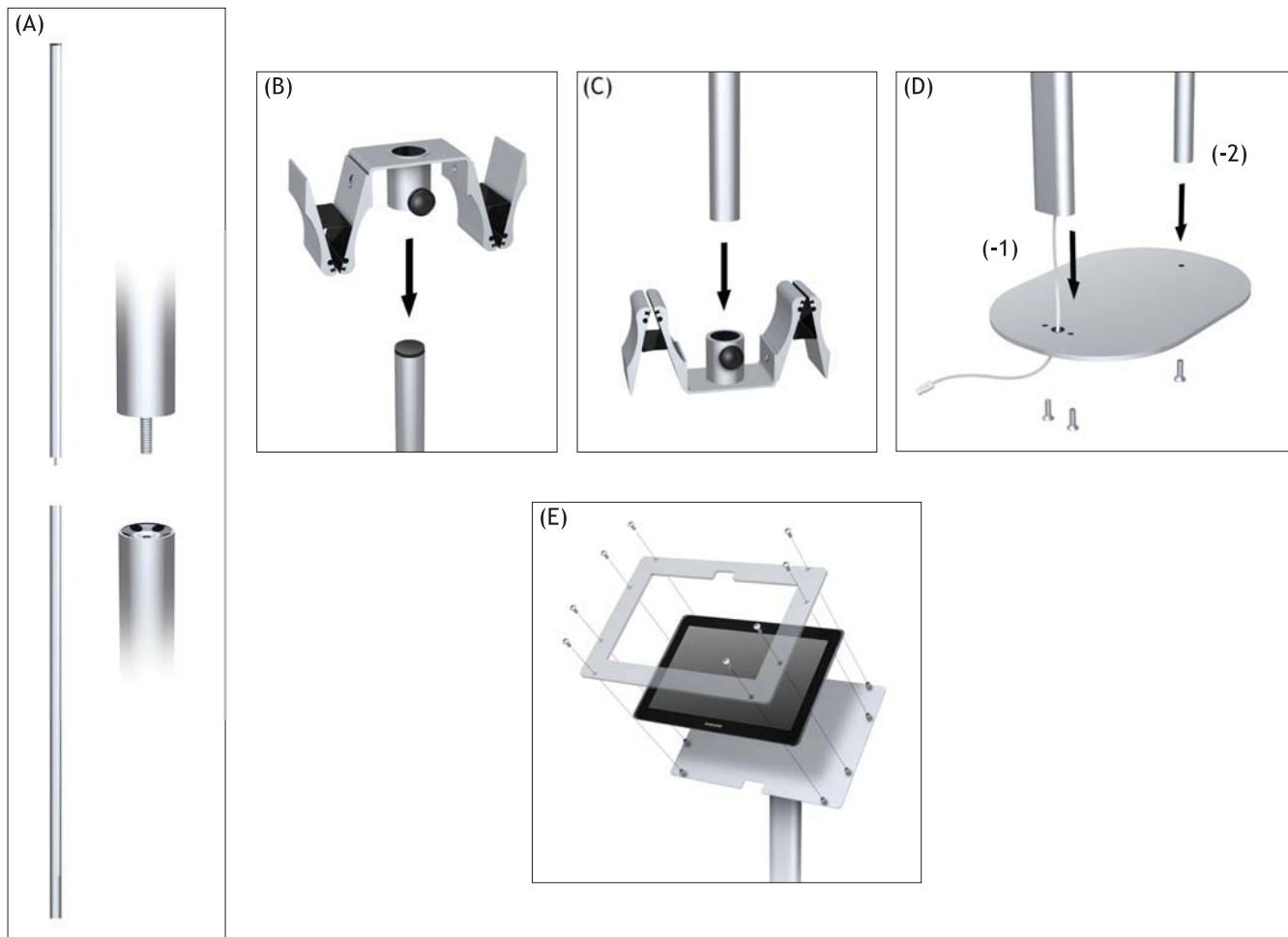

IPHC2 shown